

Metallic Valve

BS5163 PN10/PN16/PN25

BS5153 & BS5153L/W

DIN3352 F4 & F5

Y-Strainer



SRE VALVES



CONTENTS

SRE VALVES

Metallic seat gate valve series BS5163 NRS	1
Metallic seat gate valve series BS5163 NRS	2
Metallic seat gate valve series BS5163 with by pass NRS	3
Metallic seat gate valve series BS5163 with bevel box NRS	4
Metallic seat gate valve series BS5163 c/w bevel box\by pass NRS.....	5
Metallic seat gate valve series BS5163 c/w spur box\by pass NRS.....	6
Metallic seat swing check valve series BS5153	7
Metallic seat swing check valve series BS5153L/W	8
Metallic seat swing check valve series BS5153-PN25	9
Metallic seat gate valve series BS5163-PN25 NRS	10
Metallic seat gate valve series DIN3352 F4 NRS	11
Metallic seat gate valve series DIN3352 F5 NRS	12
Y-Strainer.....	13
Metallic seat globe valve series BS5152.....	14



WRAS



ISO9001 : 2008



PED/CE

ANHUI STREAM WELL VALVE CO.,LTD INTRODUCTION

Anhui Streamwell Valve Co., Ltd is a specialized production each kind of low pressure cast iron exports the valve (gray iron, ductile iron) and the pipeline fitting's Private Enterprise Strainer. The company has a total investment of 45 million yuan, and it is covering an area of 44,000 square meters, the area of structure is 35,000 square meters. The company has a modernized production workshop and production equipment, It's productivity is 12,000 ton low pressure cast iron valve per year.

The company has 360 stuff, among whom over 90 are technical

college above school record stuff, 40 are intermediate above technical title stuff, and 120 are senior technical staff in the company. It has the independent research and development ability, and it also can carry on the design and the production according to the customer's request. The company has over years experience in exporting valve, the product variety are many, the specification is entire. The main product are: BS5163、DIN3352-F4/F5、AWWA C509 and socket end soft seal gate valve; BS750 Hydrant;BS5153 (L/W) brass seal swing check Valve; BS5163 brass seal gate valve; BS5152 brass seal cut-off valve; Y-Strainer.The surface of the product can be coat, or powder static electricity spraying. The company won the European Union CE produt safe Certificate and ISO9001 Certificate and WRAS Certificate. These products have been export to Europe, American, Middle East, Africa and Southeast Asia, Africa etc and China Hongkong , Taiwan and so on.

Remarkable quality, reasonable price , complete guarantees the nature system make the company get a well user foundation and prestige. Welcome every customer from everywhere to visit and do business with us.



SPECIFICATIONS

Size	DN 40 - 300
Class	PN 10 - PN 16
Design	BS 5163
Face to Face	BS 5163 / ISO 5752 3 Series
End Flange	BS 4504 / BS EN 1092
Test	BS 5163

STANDARD MATERIALS OF MAIN PARTS

ITEM	PART NAME	MATERIAL
1	Body	Ductile Iron
2	Wedge	Ductile Iron
3	Bonnet	Ductile Iron
4	Stem	Stainless Steel 420/431/316
5	Stem Nut	Brass
6	Holding Ring	Brass
7	Sealing Ring	Brass
8	Body Ring	Brass / Bronze
9	Wedge Ring	Brass / Bronze
10	Gland	Ductile Iron
11	Handwheel	Ductile Iron
12	Bonnet Gasket	NBR
13	O Ring	NBR
14	Dust Ring	NBR
15	Bolt	Stainless steel

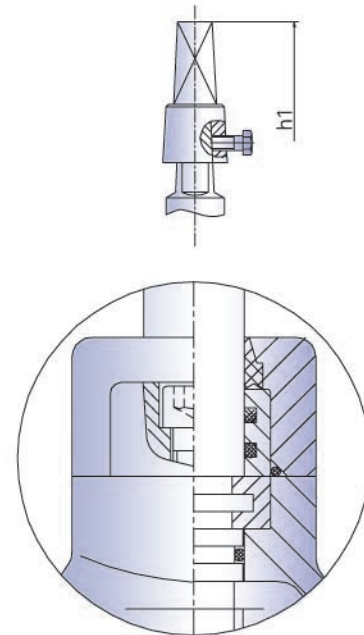
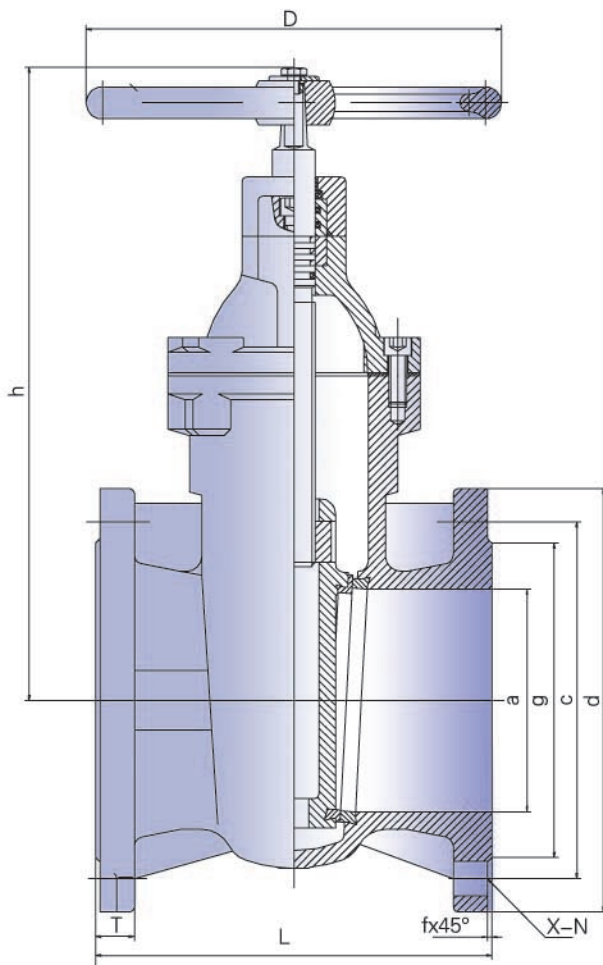
DIMENSIONS

DN	OUTLINE mm				END FLANGE BS PN10/16 mm				BS PN10/16 mm			
	L	h	D	h1	a	d	c	x-n	T	g	f	
40	165	245	180	315	40	150	110	4- ϕ 19	19	84	3	
50	178	260	180	330	50	165	125	4- ϕ 19	19	99	3	
65	190	285	180	355	65	185	145	4- ϕ 19	19	118	3	
80	203	335	205	405	80	200	160	8- ϕ 19	19	132	3	
100	229	365	240	435	100	220	180	8- ϕ 19	19	156	3	
125	254	420	240	490	125	250	210	8- ϕ 19	19	184	3	
150	267	480	280	550	150	285	240	8- ϕ 23	19	211	3	
200	292	570	320	640	200	340	295	8- ϕ 23 12- ϕ 23	20	266	3	
250	330	670	360	740	250	405	350 355	12- ϕ 23 12- ϕ 28	22	319	3	
300	356	775	450	845	300	460	400 410	12- ϕ 23 12- ϕ 28	24.5	370	4	

SPECIFICATIONS

Size	DN 350 - 600
Class	PN 10 - PN 16
Design	BS 5163
Face to Face	BS 5163 / ISO 5752 3 Series
End Flange	BS 4504 / BS EN 1092
Test	BS 5163

STANDARD MATERIALS OF MAIN PARTS

ITEM	PART NAME	MATERIAL
1	Body	Ductile Iron
2	Wedge	Ductile Iron
3	Bonnet	Ductile Iron
4	Stem	Stainless Steel 420/431/316
5	Stem Nut	Brass
6	Holding Ring	Brass
7	Sealing Ring	Brass
8	Body Ring	Brass / Bronze
9	Wedge Ring	Brass / Bronze
10	Gland	Ductile Iron
11	Handwheel	Ductile Iron
12	Bonnet Gasket	NBR
13	O Ring	NBR
14	Dust Ring	NBR

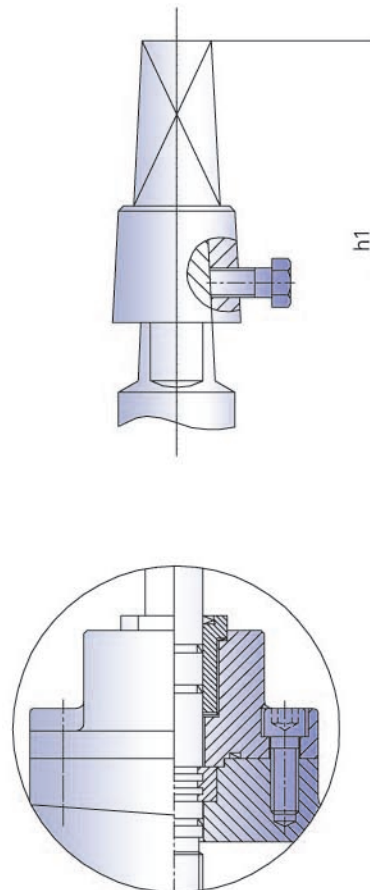
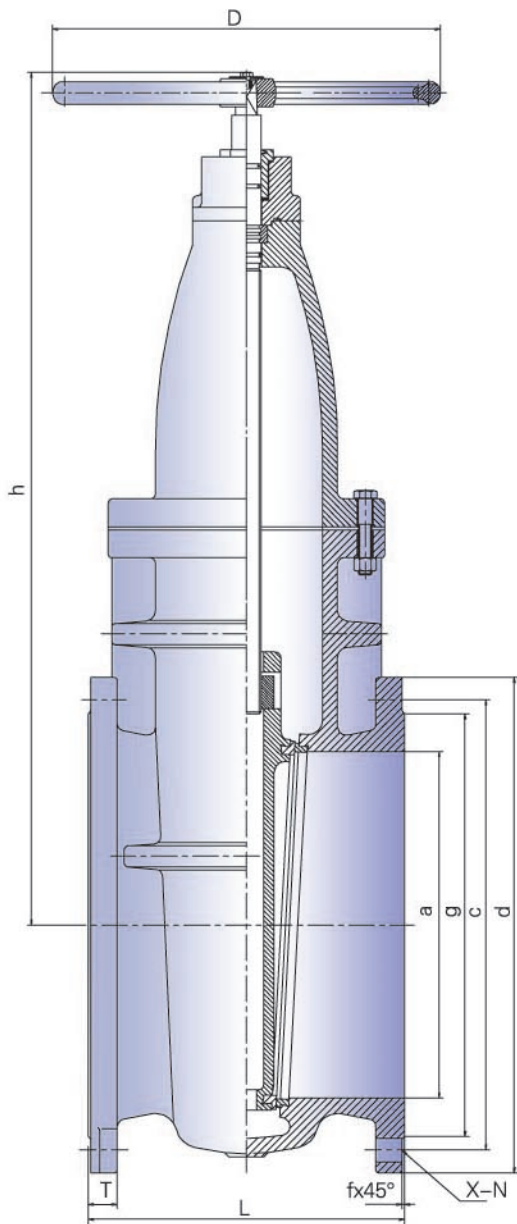

DIMENSIONS

DN	OUTLINE mm				END FLANGE BS PN10/16 mm									
	L	h	D	h1	a	d	c	x-n	T	g	f			
350	381	950	500	1030	350	520	460	470	16- ϕ 23	16- ϕ 28	26.5	429	4	
400	406	1035	560	1115	400	580	515	525	16- ϕ 28	16- ϕ 31	28	480	4	
450	432	1165	560	1245	450	640	565	585	20- ϕ 28	20- ϕ 31	30	530	548	4
500	457	1230	650	1310	500	715	620	650	20- ϕ 28	20- ϕ 34	31.5	582	609	4
600	508	1390	650	1470	600	840	725	770	20- ϕ 31	20- ϕ 37	36	682	720	5

STANDARD MATERIALS OF MAIN PARTS

ITEM	PART NAME	MATERIAL
1	Body	Ductile Iron
2	Wedge	Ductile Iron
3	Bonnet	Ductile Iron
4	Stem	Stainless Steel 420/431/316
5	Stem Nut	Brass
6	Holding Ring	Brass
7	Sealing Ring	Brass
8	Body Ring	Brass / Bronze
9	Wedge Ring	Brass / Bronze
10	Gland	Ductile Iron
11	Handwheel	Ductile Iron
12	Bonnet Gasket	NBR
13	O Ring	NBR
14	Dust Ring	NBR

SPECIFICATIONS

Size	DN 350 - 600
Class	PN 10 - PN 16
Design	BS 5163
Face to Face	BS 5163 / ISO 5752 3 Series
End Flange	BS 4504 / BS EN 1092
Test	BS 5163

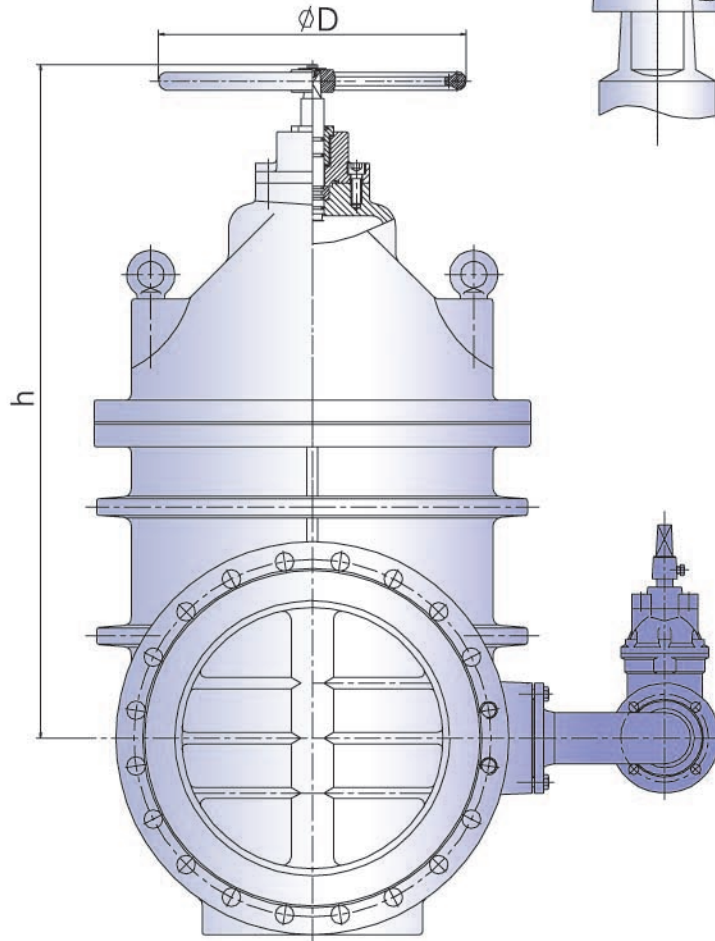
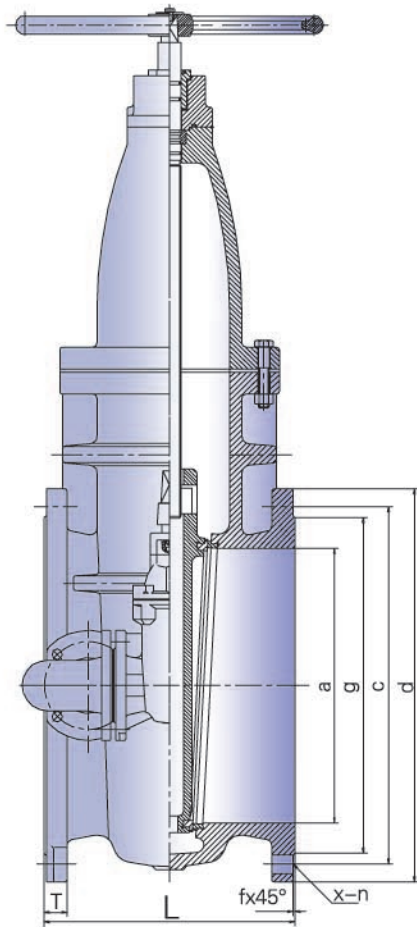
DIMENSIONS

DN	OUTLINE mm				END FLANGE BS PN10/16 mm								by pass		
	L	h	D	h1	a	d	c	x-n	T	g	f				
350	381	950	500	1030	350	520	460	470	14-ø23/2-M20	14-ø28/2-M24	26.5	429	4	DN50	
400	406	1035	560	1115	400	580	515	525	14-ø28/2-M24	14-ø31/2-M27	28	480	4	DN50	
450	432	1165	560	1245	450	640	565	585	18-ø28/2-M24	18-ø31/2-M27	30	530	548	4	DN80
500	457	1230	650	1310	500	715	620	650	18-ø28/2-M24	18-ø34/2-M30	31.5	582	609	4	DN80
600	508	1390	650	1470	600	840	725	770	18-ø31/2-M27	18-ø37/2-M33	36	682	720	5	DN80

STANDARD MATERIALS OF MAIN PARTS

ITEM	PART NAME	MATERIAL
1	Body	Ductile Iron
2	Wedge	Ductile Iron
3	Bonnet	Ductile Iron
4	Stem	Stainless Steel 420/431/316
5	Stem Nut	Brass
6	Holding Ring	Brass
7	Sealing Ring	Brass
8	Body Ring	Brass/Bronze
9	Wedge Ring	Brass/Bronze
10	Gland	Ductile Iron
11	Handwheel	Ductile Iron
12	Bonnet Gasket	NBR
13	O Ring	NBR
14	Dust Ring	NBR

SPECIFICATIONS

Size	DN 350 - 600
Class	PN 10 - PN 16
Design	BS 5163
Face to Face	BS 5163 / ISO 5752 3 Series
End Flange	BS 4504 / BS EN 1092
Test	BS 5163

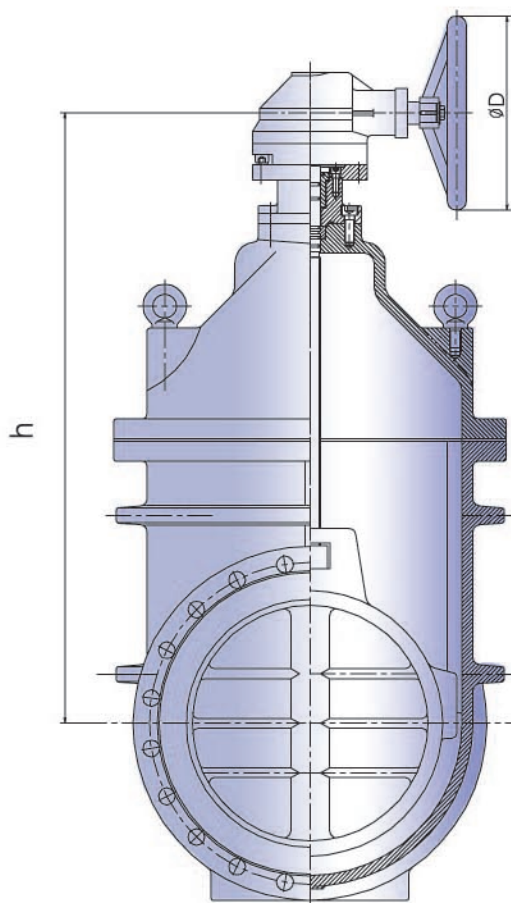
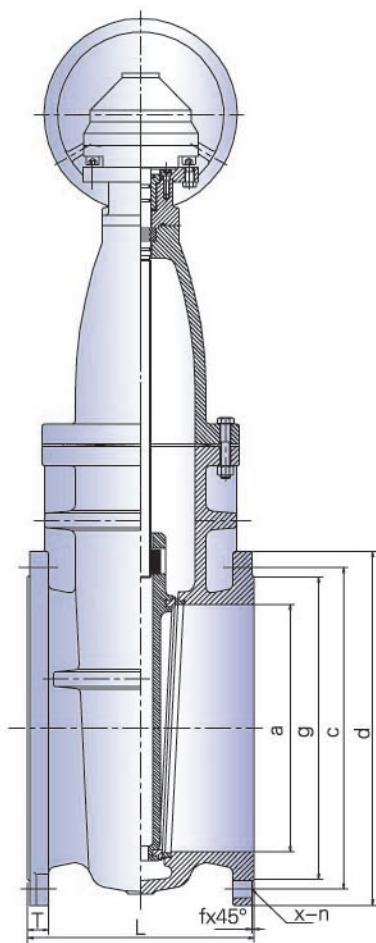

DIMENSIONS

DN	OUTLINE mm					END FLANGE		BS PN10/16 mm					
	L	h	D	a	d	c		x-n	T	g	f		
350	381	945	450	350	520	460	470	16-ø23	16-ø28	26.5	429	4	
400	406	1030	450	400	580	515	525	16-ø28	16-ø31	28	480	4	
450	432	1155	450	450	640	565	585	20-ø28	20-ø31	30	530	548	4
500	457	1270	550	500	715	620	650	20-ø28	20-ø34	31.5	582	609	4
600	508	1425	550	600	840	725	770	20-ø31	20-ø37	36	682	720	5

STANDARD MATERIALS OF MAIN PARTS

ITEM	PART NAME	MATERIAL
1	Body	Ductile Iron
2	Wedge	Ductile Iron
3	Bonnet	Ductile Iron
4	Stem	Stainless Steel 420/431/316
5	Stem Nut	Brass
6	Holding Ring	Brass
7	Sealing Ring	Brass
8	Body Ring	Brass / Bronze
9	Wedge Ring	Brass / Bronze
10	Gland	Ductile Iron
11	Handwheel	Ductile Iron
12	Bonnet Gasket	NBR
13	O Ring	NBR
14	Dust Ring	NBR

SPECIFICATIONS

Size	DN 350 - 600
Class	PN 10 - PN 16
Design	BS 5163
Face to Face	BS 5163 / ISO 5752 3 Series
End Flange	BS 4504 / BS EN 1092
Test	BS 5163

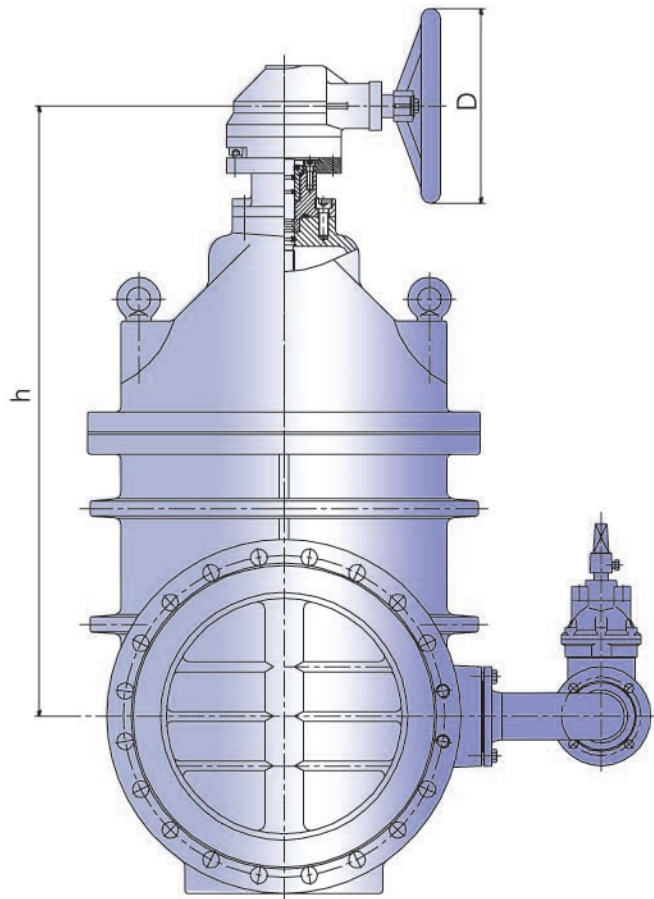
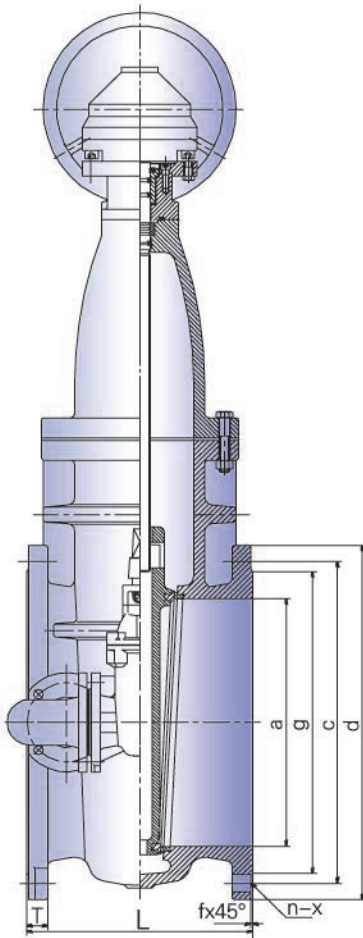
DIMENSIONS

DN	OUTLINE mm					END FLANGE			BS PN10/16 mm			by pass		
	L	h	D	a	d	c	x-n	T	g	f				
350	381	945	450	350	520	460	470	14- ϕ 23/2-M20	14- ϕ 28/2-M24	26.5	429	4	DN50	
400	406	1030	450	400	580	515	525	14- ϕ 28/2-M24	14- ϕ 31/2-M27	28	480	4	DN50	
450	432	1155	450	450	640	565	585	18- ϕ 28/2-M24	18- ϕ 31/2-M27	30	530	548	4	DN80
500	457	1270	550	500	715	620	650	18- ϕ 28/2-M24	18- ϕ 34/2-M30	31.5	582	609	4	DN80
600	508	1425	550	600	840	725	770	18- ϕ 31/2-M27	18- ϕ 37/2-M33	36	682	720	5	DN80

STANDARD MATERIALS OF MAIN PARTS

ITEM	PART NAME	MATERIAL
1	Body	Ductile Iron
2	Wedge	Ductile Iron
3	Bonnet	Ductile Iron
4	Stem	Stainless Steel 420/431/316
5	Stem Nut	Brass
6	Holding Ring	Brass
7	Sealing Ring	Brass
8	Body Ring	Brass / Bronze
9	Wedge Ring	Brass / Bronze
10	Gland	Ductile Iron
11	Handwheel	Ductile Iron
12	Bonnet Gasket	NBR
13	O Ring	NBR
14	Dust Ring	NBR

SPECIFICATIONS

Size	DN 350 - 600
Class	PN 10 - PN 16
Design	BS 5163
Face to Face	BS 5163 / ISO 5752 3 Series
End Flange	BS 4504 / BS EN 1092
Test	BS 5163

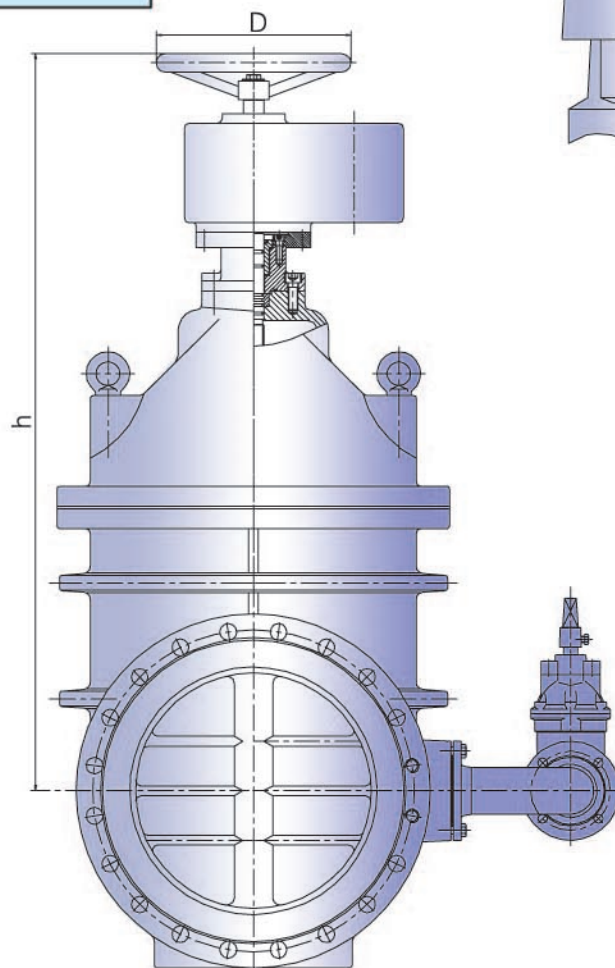
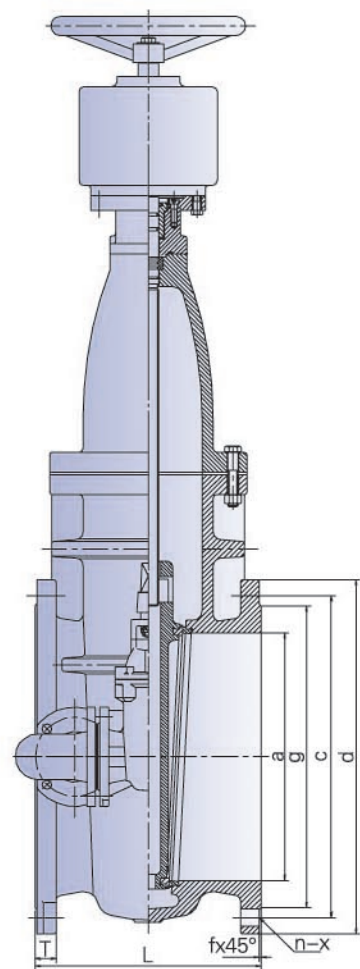

DIMENSIONS

DN	OUTLINE mm				END FLANGE				BS PN10/16 mm				by pass		
	L	h	D	h1	a	d	c	x-n	T	g	f				
350	381	1055	450	1135	350	520	460	470	14- ϕ 23/2-M20	14- ϕ 28/2-M24	26.5	429	4	DN50	
400	406	1140	450	1220	400	580	515	525	14- ϕ 28/2-M24	14- ϕ 31/2-M27	28	480	4	DN50	
450	432	1265	450	1345	450	640	565	585	18- ϕ 28/2-M24	18- ϕ 31/2-M27	30	530	548	4	DN80
500	457	1415	550	1495	500	715	620	650	18- ϕ 28/2-M24	18- ϕ 34/2-M30	31.5	582	609	4	DN80
600	508	1570	550	1650	600	840	725	770	18- ϕ 31/2-M27	18- ϕ 37/2-M33	36	682	720	5	DN80

STANDARD MATERIALS OF MAIN PARTS

ITEM	PART NAME	MATERIAL
1	Body	Ductile Iron/Cast Iron
2	Disc	Ductile Iron/Cast Iron
3	Cover	Ductile Iron/Cast Iron
4	Shaft/Pin	Stainless Steel 420/431/316
5	Shaft Nut	Ductile Iron/Cast Iron
6	Hinge	Ductile Iron
7	Body Ring	Brass / Bronze
8	Disc Ring	Brass / Bronze

SPECIFICATIONS

Size	DN50 - 400
Class	PN 10 - PN 16
Design	BS 5153
Face to Face	BS 5153
End Flange	BS 4504 / BS EN 1092
Test	BS 5153

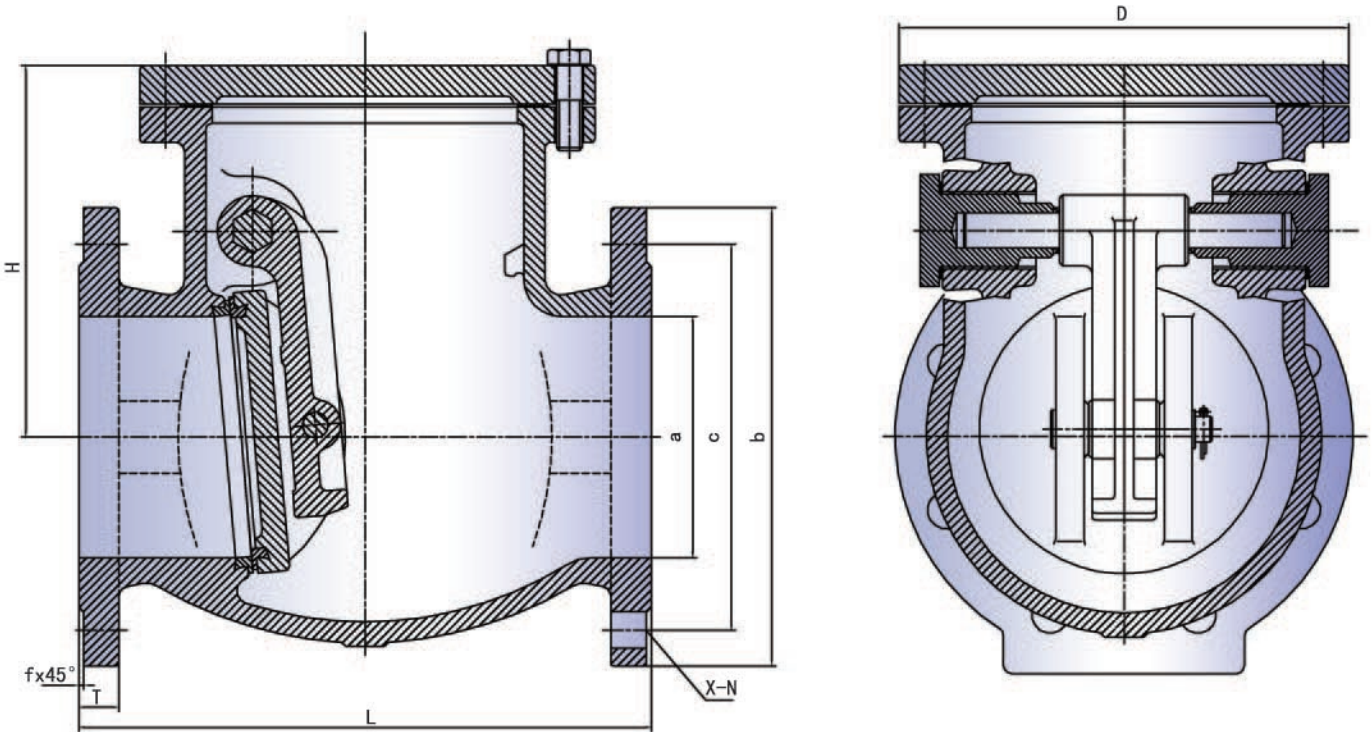
DIMENSIONS

SIZE	a	c	d	T(DI/CI)		f	L	X-N(PN10/PN16)	≈ H	D
50	50	125	165	19	20	3	203	4-∅19	135	170
65	65	145	185	19	20	3	216	4-∅19	148	176
80	80	160	200	19	22	3	241	8-∅19	178	205
100	100	180	220	19	24	3	292	8-∅19	195	220
125	125	210	250	19	26	3	330	8-∅19	210	265
150	150	240	285	19	26	3	356	8-∅23	250	295
200	200	295	340	20	30	3	495	8-∅23 12-∅23	300	370
250	250	355	405	22	32	3	622	12-∅23 12-∅28	335	430
300	300	410	460	24.5	32	4	698	12-∅23 12-∅28	365	505
350	350	470	520	26.5	36	4	787	16-∅23 16-∅28	415	610
400	400	525	580	28	38	4	914	16-∅28 16-∅31	455	685

STANDARD MATERIALS OF MAIN PARTS

ITEM	PART NAME	MATERIAL
1	Body	Ductile Iron/Cast Iron
2	Disc	Ductile Iron/Cast Iron
3	Cover	Ductile Iron/Cast Iron
4	Shaft/Pin	Stainless Steel 420/431/316
5	Shaft Nut	Ductile Iron/Cast Iron
6	Hinge	Ductile Iron
7	Body Ring	Brass /Bronze
8	Disc Ring	Brass /Bronze
9	Lever	Carbon Steel
10	Weight	Ductile Iron/Cast Iron

SPECIFICATIONS

Size	DN50 - 400
Class	PN 10 - PN 16
Design	BS 5153
Face to Face	BS 5153
End Flange	BS 4504 / BS EN 1092
Test	BS 5153

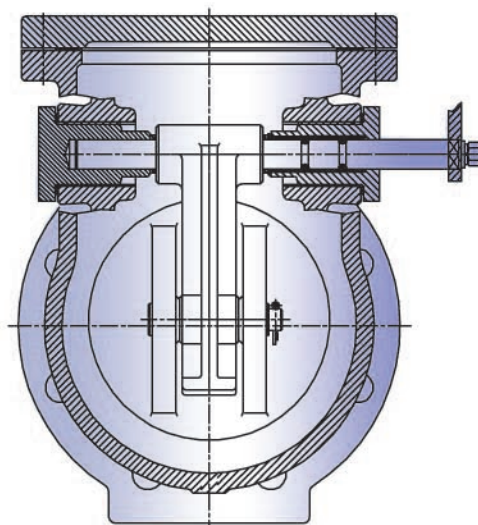
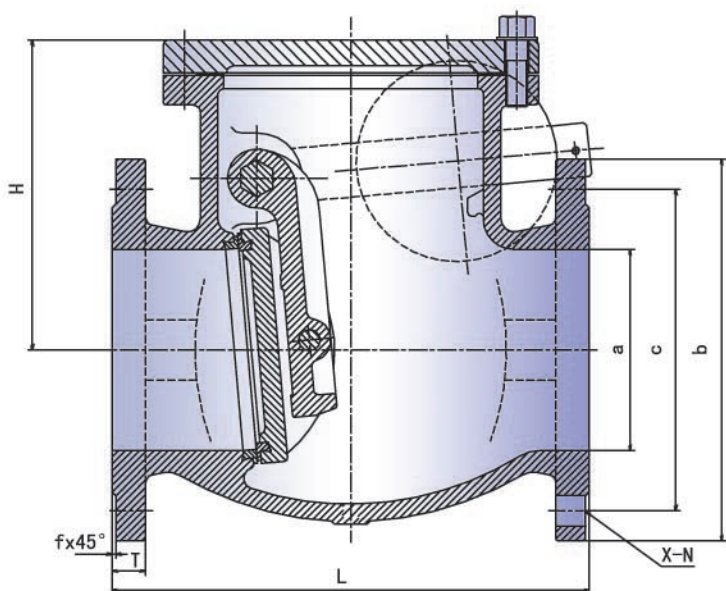
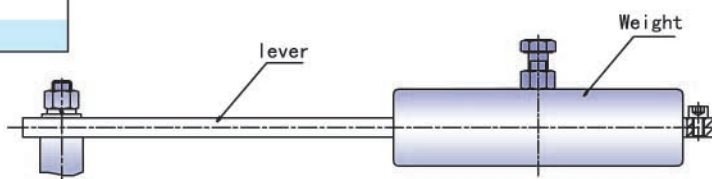

DIMENSIONS

SIZE	a	c	d	T(DI/CI)		f	L	X-N(PN10/PN16)	≈H	D
50	50	125	165	19	20	3	203	4-∅19	135	170
65	65	145	185	19	20	3	216	4-∅19	148	176
80	80	160	200	19	22	3	241	8-∅19	178	205
100	100	180	220	19	24	3	292	8-∅19	195	220
125	125	210	250	19	26	3	330	8-∅19	210	265
150	150	240	285	19	26	3	356	8-∅23	250	295
200	200	295	340	20	30	3	495	8-∅23 12-∅23	300	370
250	250	355	405	22	32	3	622	12-∅23 12-∅28	335	430
300	300	410	460	24.5	32	4	698	12-∅23 12-∅28	365	505
350	350	470	520	26.5	36	4	787	16-∅23 16-∅28	415	610
400	400	525	580	28	38	4	914	16-∅28 16-∅31	455	685

STANDARD MATERIALS OF MAIN PARTS

ITEM	PART NAME	MATERIAL
1	Body	Ductile Iron/Cast Iron
2	Disc	Ductile Iron/Cast Iron
3	Cover	Ductile Iron/Cast Iron
4	Shaft/Pin	Stainless Steel 420/431/316
5	Shaft Nut	Ductile Iron/Cast Iron
6	Hinge	Ductile Iron
7	Body Ring	Brass /Bronze
8	Disc Ring	Brass /Bronze

SPECIFICATIONS

Size	DN80 - 300
Class	PN25
Design	BS 5153
Face to Face	BS 5153
End Flange	BS 4504 / BS EN 1092
Test	BS 5153

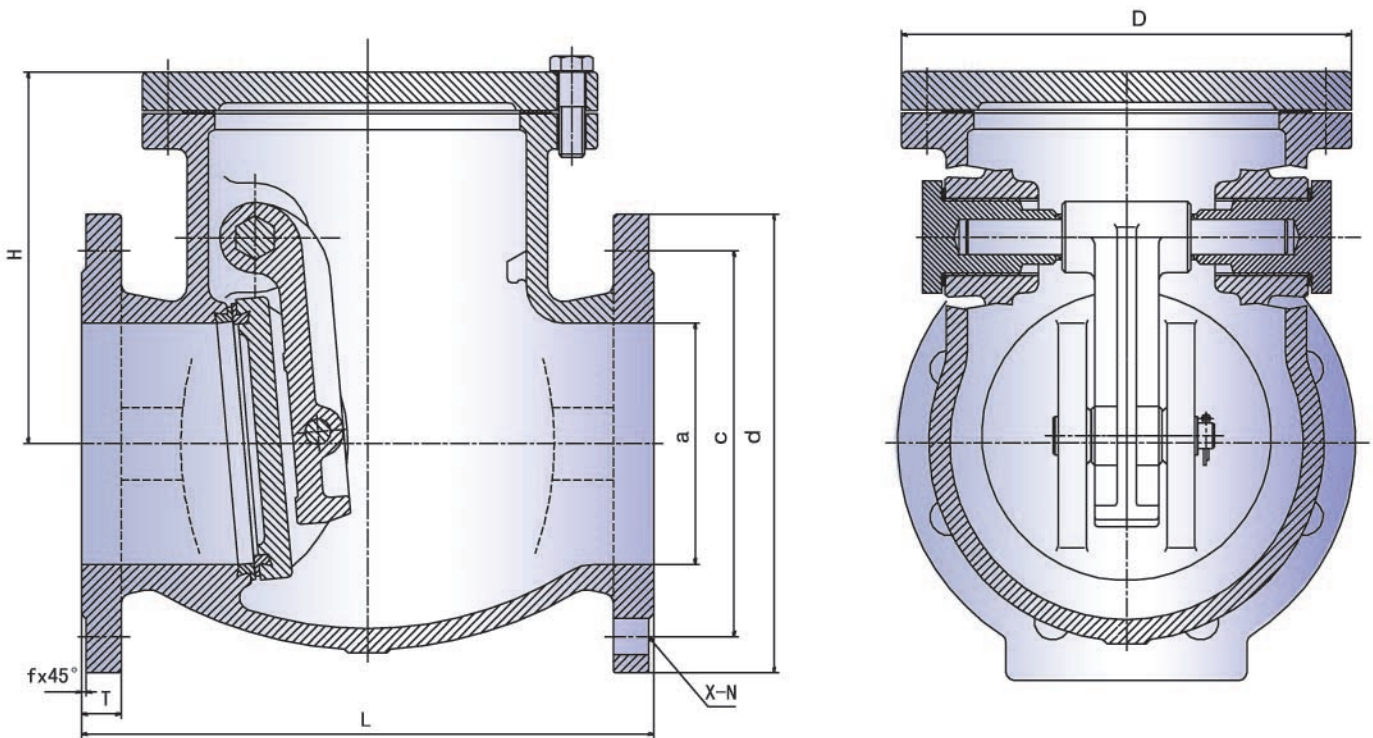
DIMENSIONS

SIZE	a	c	d	T(DI/CI)	f	L	X-N(PN25)	≈ H	D
80	80	160	200	19	22	3	8- ϕ 19	178	205
100	100	190	235	19	24	3	8- ϕ 23	195	220
150	150	250	300	19	26	3	8- ϕ 28	250	295
200	200	310	360	20	30	3	12- ϕ 28	300	370
250	250	430	425	22	32	3	12- ϕ 31	335	430
300	300	370	485	24.5	32	4	16- ϕ 31	365	505

SPECIFICATIONS

Size	DN50 - 300
Class	PN25
Design	BS 5163
Face to Face	BS 5163 / ISO 5752 3 Series
End Flange	BS 4504 / BS EN 1092
Test	BS 5163

STANDARD MATERIALS OF MAIN PARTS

ITEM	PART NAME	MATERIAL
1	Body	Ductile Iron
2	Wedge	Ductile Iron
3	Bonnet	Ductile Iron
4	Stem	Stainless Steel 420/431/316
5	Stem Nut	Brass
6	Holding Ring	Brass
7	Sealing Ring	Brass
8	Body Ring	Brass /Bronze
9	Wedge Ring	Brass /Bronze
10	Gland	Ductile Iron
11	Handwheel	Ductile Iron
12	Bonnet Gasket	NBR
13	O Ring	NBR
14	Dust Ring	NBR

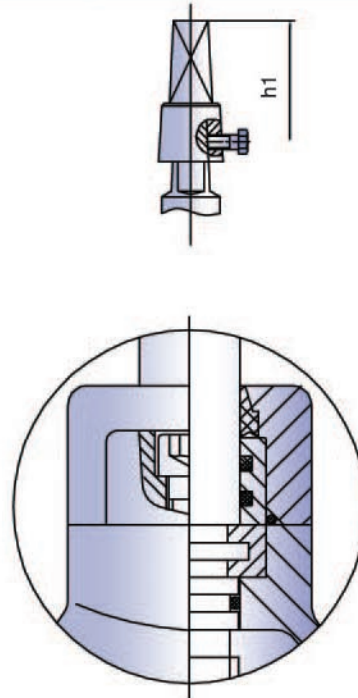
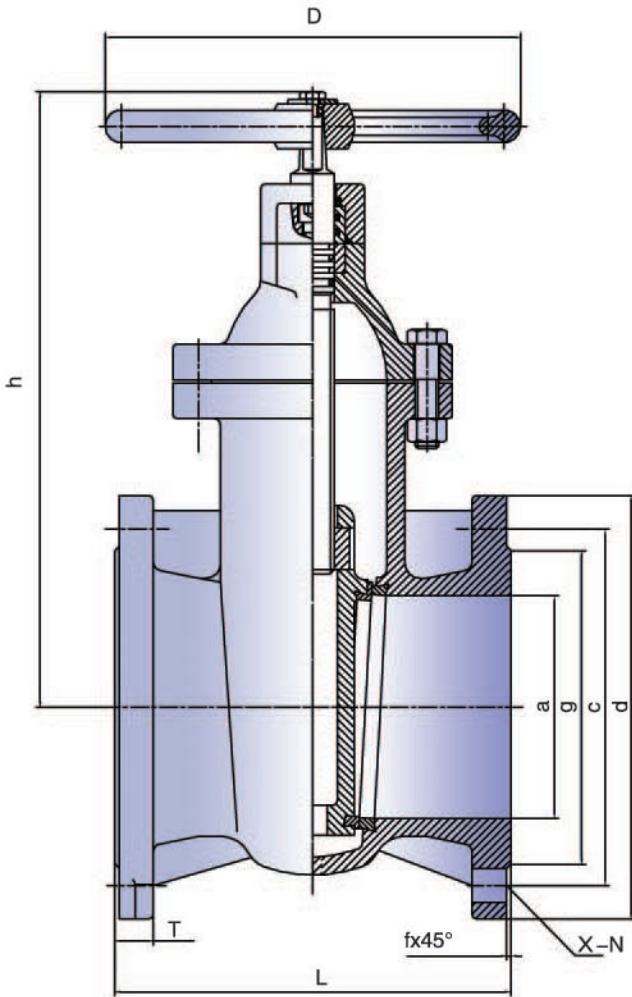

DIMENSIONS

DN	OUTLINE mm				END FLANGE PN25 mm			mm			
	L	h	D	h1	a	d	c	x-n	T	g	f
50	178	260	180	330	50	165	125	4- ϕ 19	19	99	3
65	190	285	180	355	65	185	145	8- ϕ 19	19	118	3
80	203	335	205	405	80	200	160	8- ϕ 19	19	132	3
100	229	365	240	435	100	235	190	8- ϕ 23	19	156	3
150	267	480	280	550	150	300	250	8- ϕ 28	20	211	3
200	292	570	320	640	200	360	310	12- ϕ 28	22	274	3
250	330	670	360	740	250	425	370	12- ϕ 31	24.5	330	3
300	356	775	450	845	300	485	430	16- ϕ 31	27.5	389	4

SPECIFICATIONS

Size	DN 40 - 300
Class	PN 10 - PN 16
Design	DIN3352
Face to Face	DIN3202 F4/ISO 5752 14 Series
End Flange	BS 4504 / BS EN 1092
Test	DIN3352

STANDARD MATERIALS OF MAIN PARTS

ITEM	PART NAME	MATERIAL
1	Body	Gray Cast Iron
2	Wedge	Gray Cast Iron
3	Bonnet	Gray Cast Iron
4	Stem	Stainless Steel 420/431/316
5	Stem Nut	Brass
6	Holding Ring	Brass
7	Sealing Ring	Brass
8	Body Ring	Brass/Bronze
9	Wedge Ring	Brass/Bronze
10	Gland	Gray Cast Iron
11	Handwheel	Gray Cast Iron
12	Bonnet Gasket	NBR
13	O Ring	NBR
14	Dust Ring	NBR

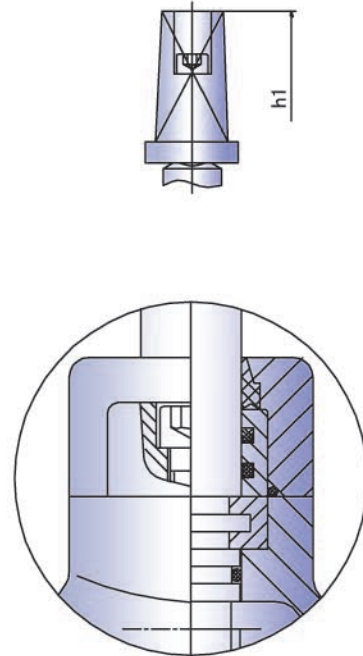
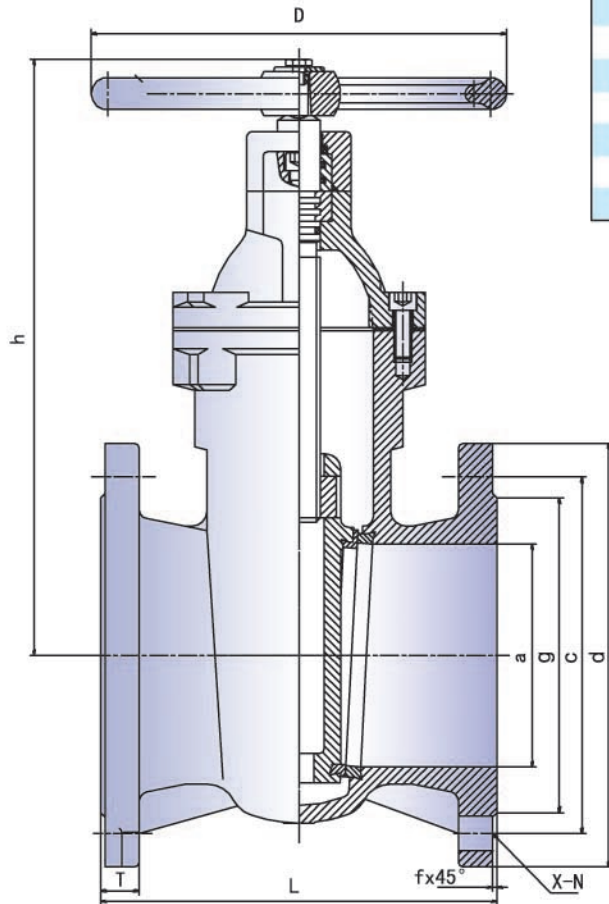
DIMENSIONS

DN	OUTLINE mm			END FLANGE BS PN10/16 mm								
	L	h	D	h1	a	d	c	x-n		T	g	f
40	140	225	150	270	40	150	110	4- ϕ 19		18	84	3
50	150	235	150	280	50	165	125	4- ϕ 19		20	99	3
65	170	265	150	310	65	185	145	4- ϕ 19		20	118	3
80	180	290	180	335	80	200	160	8- ϕ 19		22	132	3
100	190	325	180	370	100	220	180	8- ϕ 19		24	156	3
125	200	390	240	435	125	250	210	8- ϕ 19		26	184	3
150	210	435	280	480	150	285	240	8- ϕ 23		26	211	3
200	230	530	320	575	200	340	295	8- ϕ 23	12- ϕ 23	30	266	3
250	250	590	360	635	250	405	350	12- ϕ 23	12- ϕ 28	32	319	3
300	270	720	450	765	300	460	400	12- ϕ 23	12- ϕ 28	32	370	4

SPECIFICATIONS

Size	DN 40 - 300
Class	PN 10 - PN 16
Design	DIN3352
Face to Face	DIN3202 F4/ISO 5752 14 Series
End Flange	BS 4504 / BS EN 1092
Test	DIN3352

STANDARD MATERIALS OF MAIN PARTS

ITEM	PART NAME	MATERIAL
1	Body	Gray Cast Iron
2	Wedge	Gray Cast Iron
3	Bonnet	Gray Cast Iron
4	Stem	Stainless Steel 420/431/316
5	Stem Nut	Brass
6	Holding Ring	Brass
7	Sealing Ring	Brass
8	Body Ring	Brass / Bronze
9	Wedge Ring	Brass / Bronze
10	Gland	Gray Cast Iron
11	Handwheel	Gray Cast Iron
12	Bonnet Gasket	NBR
13	O Ring	NBR
14	Dust Ring	NBR

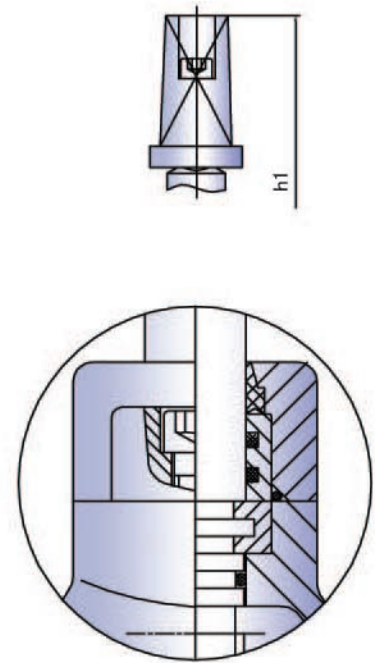
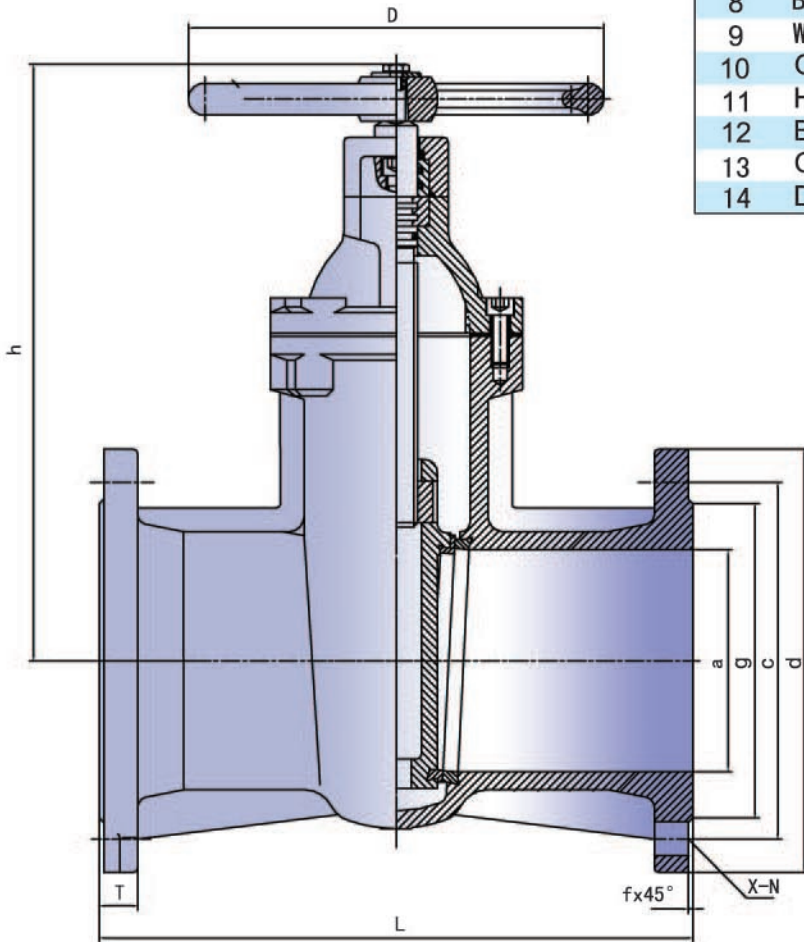

DIMENSIONS

DN	OUTLINE mm				END FLANGE BS PN10/16 mm							
	L	h	D	h1	a	d	c	x-n	T	g	f	
40	240	225	150	270	40	150	110	4-ø19	18	84	3	
50	250	235	150	280	50	165	125	4-ø19	20	99	3	
65	270	265	150	310	65	185	145	4-ø19	20	118	3	
80	280	290	180	335	80	200	160	8-ø19	22	132	3	
100	300	325	180	370	100	220	180	8-ø19	24	156	3	
125	325	390	240	435	125	250	210	8-ø19	26	184	3	
150	350	435	280	480	150	285	240	8-ø23	26	211	3	
200	400	530	320	575	200	340	295	8-ø23 12-ø23	30	266	3	
250	450	590	360	635	250	405	350 355	12-ø23 12-ø28	32	319	3	
300	500	720	450	765	300	460	400 410	12-ø23 12-ø28	32	370	4	

STANDARD MATERIALS OF MAIN PARTS

ITEM	PART NAME	MATERIAL
1	Body	Ductile Iron
2	Disc	Ductile Iron
3	Pin	Stainless Steel 304
4	Hinge	Ductile Iron
5	Body Ring	Brass/Bronze
6	Disc Ring	Brass/Bronze

SPECIFICATIONS

Size	DN80 - 600
Class	PN16
Test	BS 6755

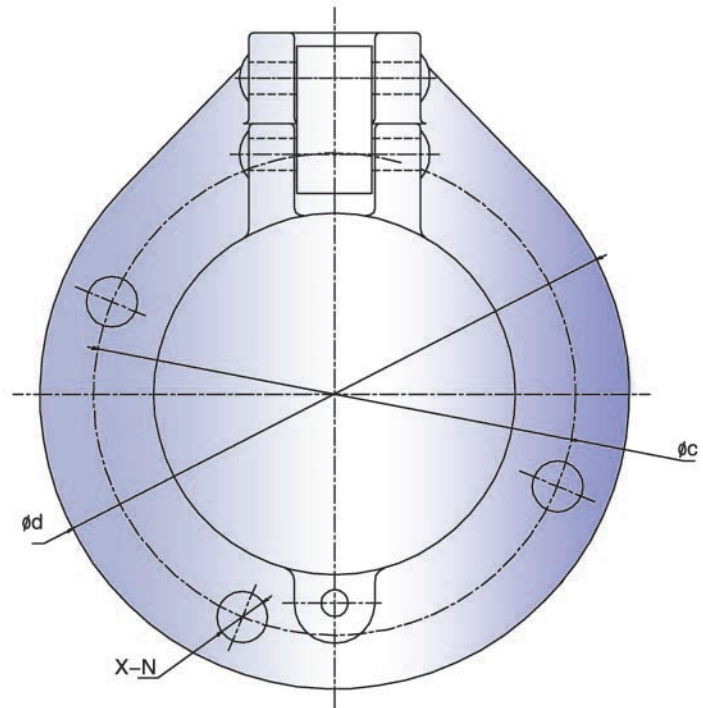
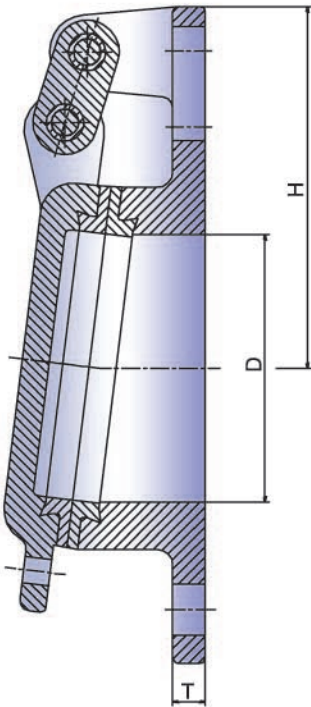
DIMENSIONS

SIZE	a	c	d	T	X-N	$\approx H$
80	80	160	200	10	4- $\phi 19$	125
100	100	180	220	10	4- $\phi 19$	135
150	150	240	285	10	4- $\phi 23$	173
200	200	295	332	13	4- $\phi 23$	202.5
225	225	324	368	13	4- $\phi 19$	220
250	250	355	400	13	4- $\phi 28$	238
300	300	410	455	15	4- $\phi 28$	268
350/375	375	470/495	550	15	4- $\phi 28$ /4- $\phi 25$	313.5
400	400	525	580	15	4- $\phi 31$	322
450	450	410	640	15	4- $\phi 31$	330
500	500	470	715	16	4- $\phi 33$	392
600	600	525	840	16	4- $\phi 33$	450

STANDARD MATERIALS OF MAIN PARTS

ITEM	PART NAME	MATERIAL
1	Body	Cast Iron
2	Bonnet	Cast Iron
3	Screen	SS304
4	Bonnet Gasket	NBR
5	Drain cock	Cast Iron/ Carbon steel

SPECIFICATIONS

Size	DN 25 - 300
Class	PN16
End Flange	BS 4504 / BS EN 1092
Test	BS6755
Design	
Face to Face	

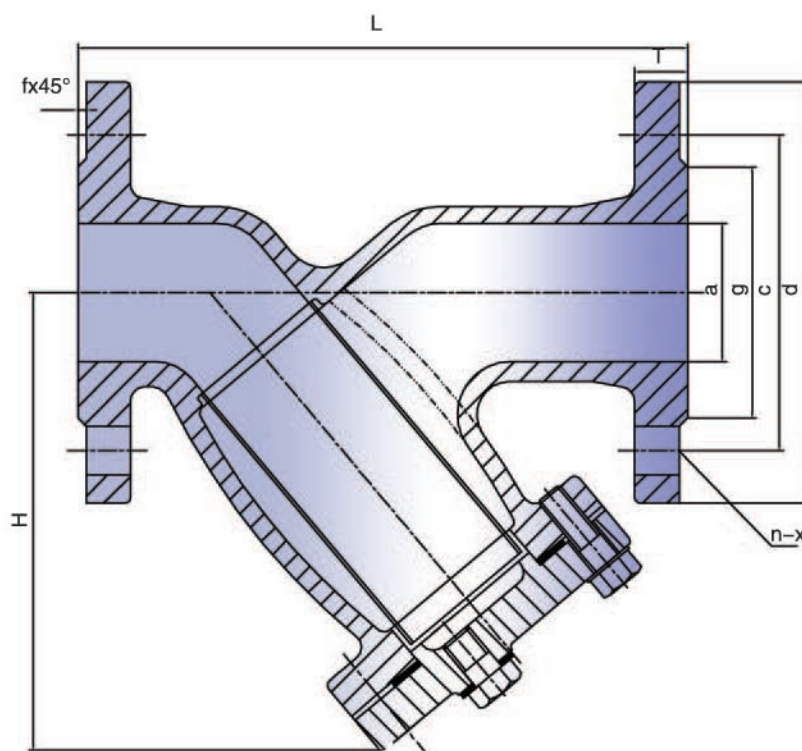

DIMENSIONS

DN	L		d	c	g	T	f	n-X	≈H
	BS Standard	DIN3202-F1							
25		160	115	85	66	16	2	4-∅15	116
32		180	140	100	76	18	3	4-∅19	132
40		200	150	110	88	18	3	4-∅19	140
50	220	230	165	125	102	20	3	4-∅19	165
65	270	290	185	145	122	20	3	4-∅19	180
80	290	310	200	160	138	22	3	8-∅19	200
100	350	350	220	180	158	24	3	8-∅19	245
125	390	400	250	210	188	26	3	8-∅19	285
150	440	480	285	240	212	26	3	8-∅23	330
200	540	600	340	295	268	30	3	12-∅23	425
250	660	730	405	355	320	32	3	12-∅28	510
300	720	850	460	410	378	32	4	12-∅28	575

SPECIFICATIONS

Size	DN50 - 300
Class	PN16
Design	BS 5152
Face to Face	BS 5152
End Flange	BS 4504 / BS EN 1092
Test	BS 5152

STANDARD MATERIALS OF MAIN PARTS

ITEM	PART NAME	MATERIAL
1	Body	Cast Iron
2	Disc	Cast Iron
3	Cover	Cast Iron
4	Stem	Stainless Steel 420/431/31
5	Stem Nut	Cast Iron
6	Seated Nut	Brass
7	Body Ring	Brass / Bronze
8	Disc Ring	Brass / Bronze

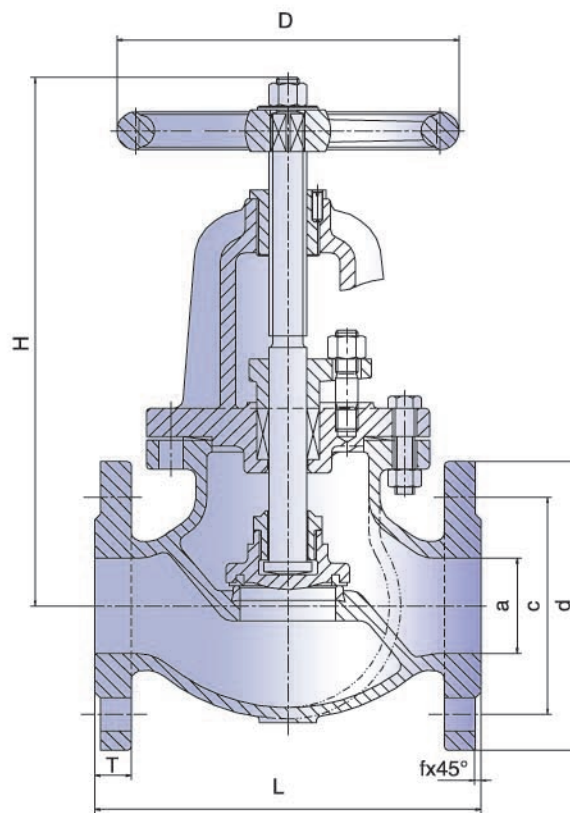
DIMENSIONS

SIZE	a	c	d	T	f	L	x-n	D	H
50	50	125	165	20	3	203	4- ϕ 19	180	280
65	65	145	185	20	3	216	4- ϕ 19	180	300
80	80	160	200	22	3	241	8- ϕ 19	200	320
100	100	180	220	24	3	292	8- ϕ 19	225	350
125	125	210	250	26	3	330	8- ϕ 19	280	390
150	150	240	285	26	3	356	8- ϕ 23	315	430
200	200	295	340	30	3	495	12- ϕ 23	355	510
250	250	355	405	32	3	622	12- ϕ 28	400	590
300	300	410	460	32	4	698	12- ϕ 28	450	630





ANHUI STREAM WELL VALVE CO., LTD

Add: No.368, Zhujiang Road(S), Mudu, Suzhou, China215101

Tel: 0086-512-66582398

Fax: 0086-512-66582908

Email: info@srevalve.com URL: [Http://www.srevalve.com](http://www.srevalve.com)